

Dr. Fritz®

Suc 3-09E

Suction, irrigation and coagulation
with one movement of your hand

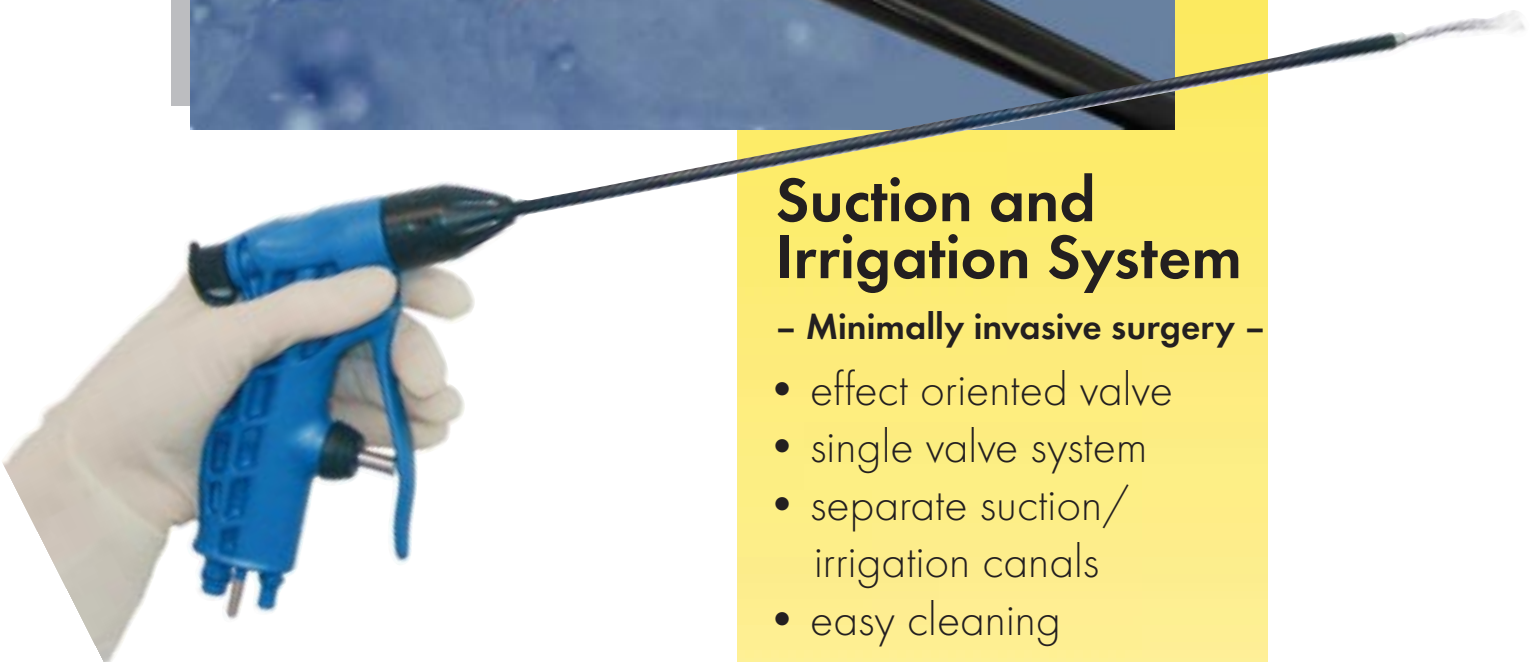
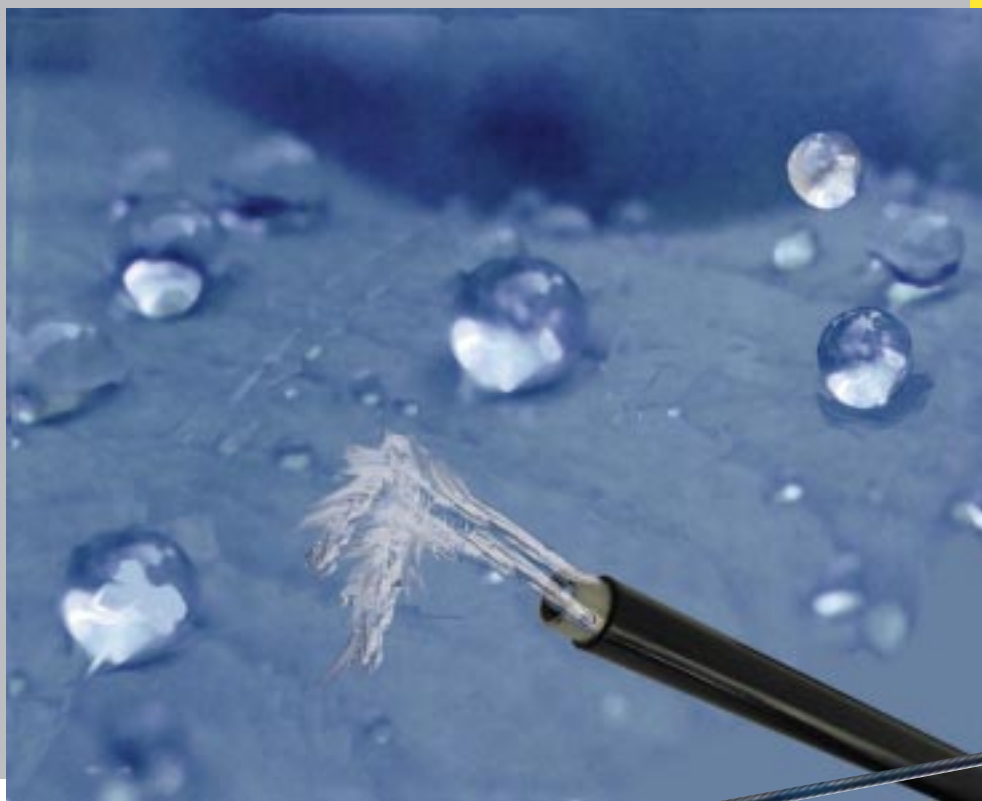

Suction and Irrigation System

– Minimally invasive surgery –

- effect oriented valve
- single valve system
- separate suction/irrigation canals
- easy cleaning
- ergonomic

Suction and irrigation system

This new generation of a suction and irrigation system has enormous advantages for the surgeon and the staff. The different functions like suction or irrigation are activated in a logical follow up in only one single valve. Forget about the everlasting problem of which button you have to choose for suction or irrigation in conventional systems. This is possible by the new patented valve construction. There, both functions are located in one valve in a design of every day use, like an air blow grip. Another advantage is the self cleaning effect of the valve construction. Blood or tissue parts will be removed mechanically by the next use of the valve.

We also placed great emphasis in developing a two way system for irrigation and suction canals, which means both ways are totally separated up to the tip of the instrument (10 and 5mm diameter tubes). Suction material is not diluted with flushing fluid again.

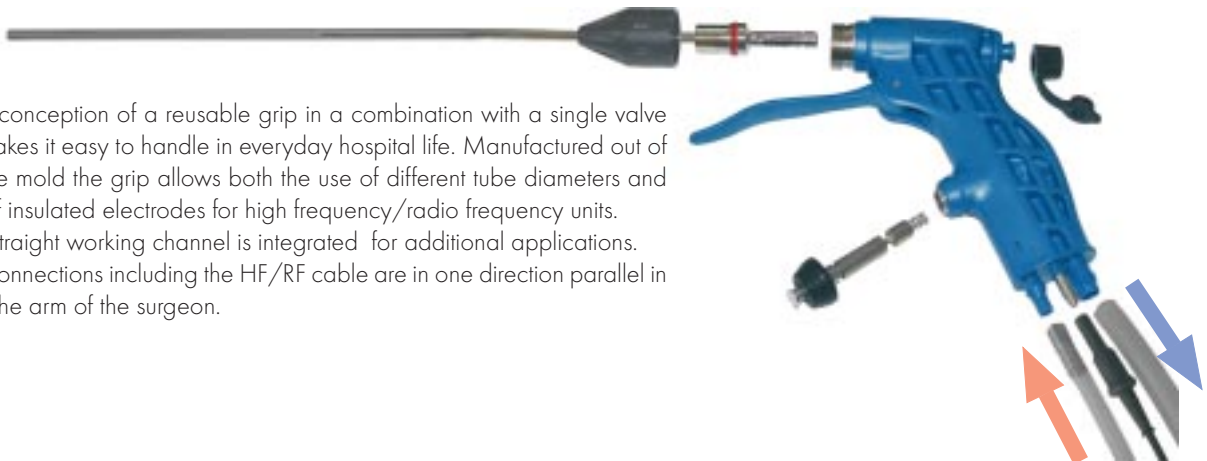

The new conception of a reusable grip in a combination with a single valve system makes it easy to handle in everyday hospital life. Manufactured out of one single mold the grip allows both the use of different tube diameters and the use of insulated electrodes for high frequency/radio frequency units. A 3 mm straight working channel is integrated for additional applications. All tube connections including the HF/RF cable are in one direction parallel in line with the arm of the surgeon.

Suction, irrigation and coagulation with one valve

One canal for irrigation and suction (standard technique)

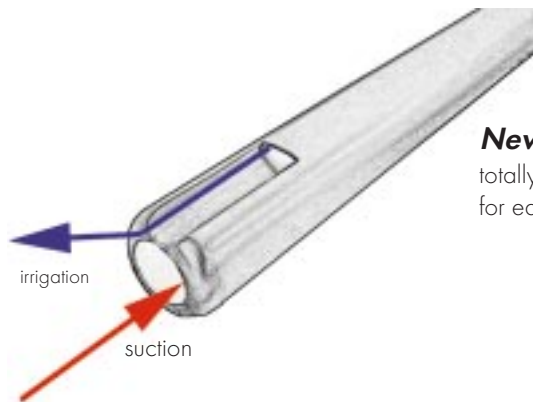
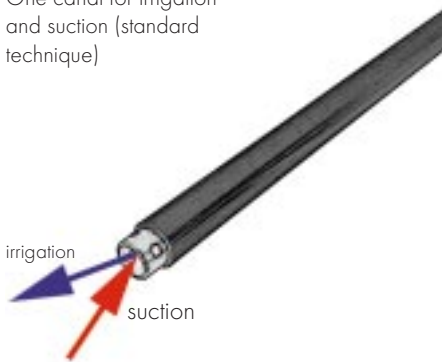

New:
totally separated canals for each function

Basic function suction/irrigation

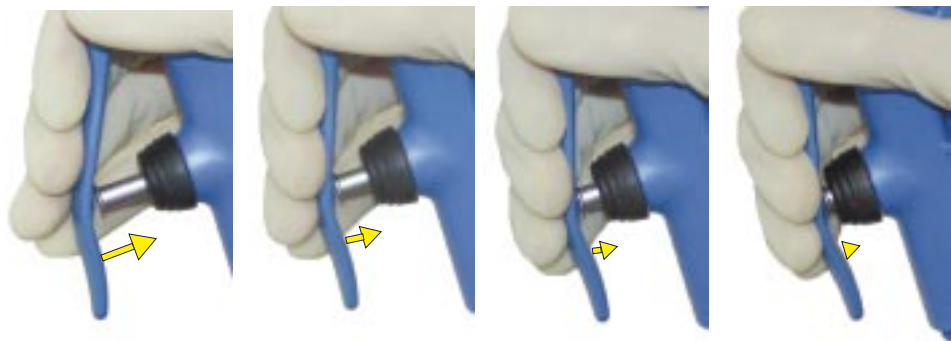

no function

1. Valve mounted, standard position.

suction

2. Smooth pressure, suction starts.

intermediate stop

3. Stronger pressure, suction stops.

irrigation

4. Full pressure, fluid irrigation.

Tubes, Accessories:



RH18 Suction/irrigation valve
compatible to RH98, metal version, incl. seal cup



RH18-D10 Spare valve cap, Silicon, for RH18, pack with 5 pc.



RH99-56 Cap for instrument channel
compatible for suction/irrigation handle RH98, pack with 5 pc.



RH99-64 O- ring set à 3x5 pieces (large, middle, small)



DE-3-456-E Cleaning brush for long tubes, size: ID: 2,5 - 5 mm

RH99-47 Silicon Oil, approved, 15 ml (without picture)

3 and 5 mm tubes, single canal



SM1-53, Suction tube, metal, standard, with fixation screw (RH99-5)



SK1-53, Suction tube, insulated, with fixation screw

Sheaths:



metal



metal



isolated

Tube Ø	length	article no.	Handle	complete	
				suction/irrigation instr.	suction/irrigation way
3 mm	21 cm	SM1-32	RH98	SM1-32RH98	1 (one canal)
	30 cm	SM1-33	"	SM1-33RH98	1
5 mm	21 cm	SM1-52	"	SM1-52RH98	1
	30 cm	SM1-53	"	SM1-53RH98	1
	37 cm	SM1-54	"	SM1-54RH98	1
5 mm	30 cm	SM2-53	"	SM2-53RH98	1
	37 cm	SM2-54	"	SM2-54RH98	1
5 mm	21 cm	SK1-52	"	SK1-52RH98	1
	30 cm	SK1-53	"	SK1-53RH98	1
	37 cm	SK1-54	"	SK1-54RH98	1

10 mm Tubes, separate canals



S9-13T2, Suction tube, complete, with inner tube and fixation screw (RH99-10)



13T2, outer tube, metal



S9-13, inner tube, with fixation screw (RH99-10), compatible to outer tubes 13T2-6

Sheaths:



Olive, metal



Tube Ø	length	article no.		Handle	complete	
		inner	outer tube		suction/irrigation instr.	suction/irrigation way
10 mm	30 cm	S9-13	13T2	RH98	S9-13T2RH98	2 (separate canals)
10 mm	30 cm	"	13T3	"	S9-13T3RH98	2
10 mm	30 cm	"	13T4	"	S9-13T4RH98	2
10 mm	30 cm	"	13T5	"	S9-13T5RH98	2
10 mm	30 cm	"	13T6	"	S9-13T6RH98	2

Suction-/Irrigation-System by Dr. Fritz

distributed by:

